

EVFC($\phi 6.7$)

Fuses to protect auxiliary system circuits such as electric compressors and DC/DC converters

EVF



General Specification

| | |
|-----------------------------|---------------|
| Rated Voltage | DC450V |
| Breaking Capacity | 2000A |
| Recommended Operating Temp. | -40°C~100°C*2 |
| Standard | — |
| Country of Origin | China |
| Plating | Ni Plating |
| Standard Packaging | 400 |
| Insertion Force | — |
| Pull-out Load | — |
| Recommended Torque | (2.1±0.2)N·m |

*2 Please contact us for the details of operating temperature.

Dimensions

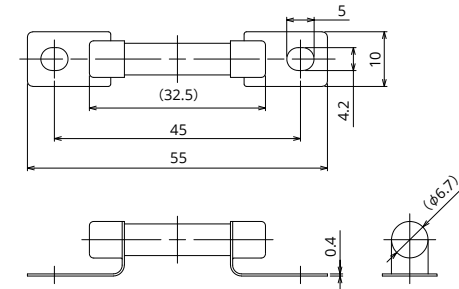

Product Lineup

| Ampere Rating(A) | Part Number | Bolt Size | Diameter | Resistance Value | Voltage Drop |
|------------------|-------------|-----------|------------|------------------|--------------|
| 1 | 2704 | M4 | $\phi 6.7$ | 645.0 m Ω | Coming up |
| 5 | 2705 | | | 43.0 m Ω | |

*In case a product other than the ones published in the document is desired, please contact us.
 *This product is under development, so please contact us for the details.

Time-Current Characteristic

| % of Ampere Rating(A) | Operating Time | |
|-----------------------|----------------|---------|
| | Min | Max |
| 110% | 100hrs. | — |
| 350% | — | 0.5sec. |
| 600% | — | 0.2sec. |

*The fuse characteristic may change depending on the conditions of use.

Time-Current Characteristic Chart

